

MODEST MOVE-UP

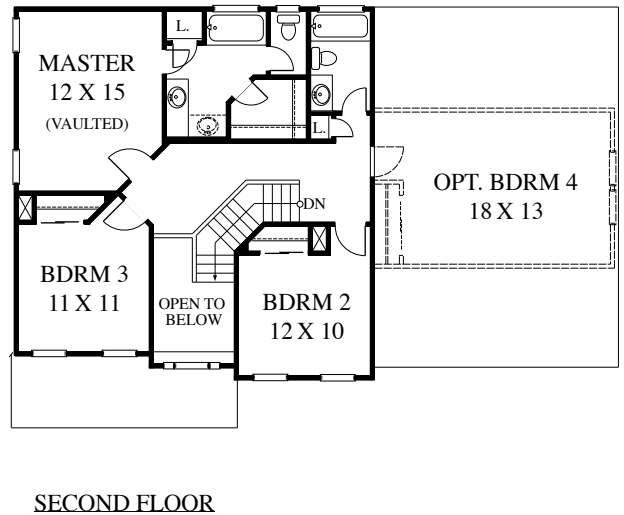
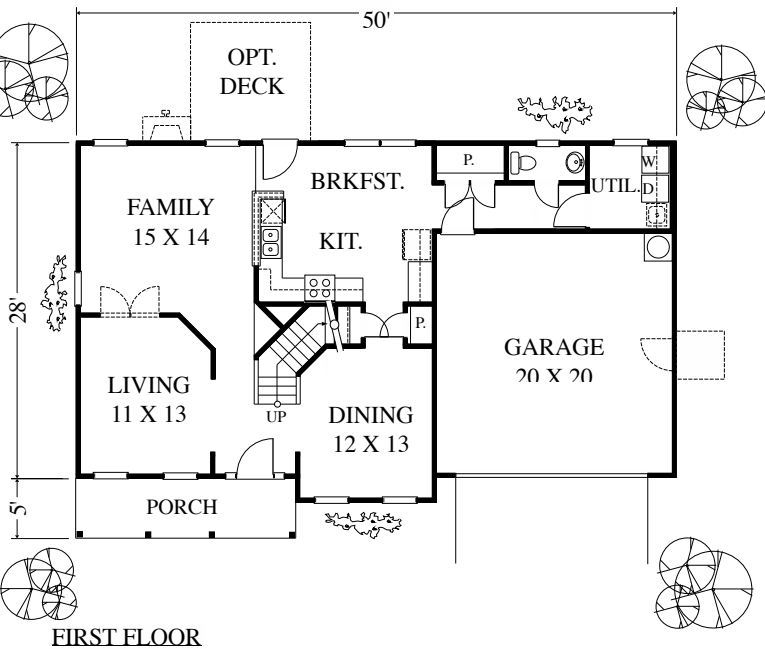

Copyright 2000 by James Wentling/Architects

113-05 D THE SAWYER 1864/2120 SQ FT

This move-up plan includes formal living and dining rooms, a sunny kitchen and breakfast area and a large family room. Upstairs are three bedrooms plus an optional room over the garage, which could be converted to a fourth bedroom. This plan is documented with a slab foundation and a crawl alternate and includes two alternate elevations.

PRICE B

JAMES WENTLING / ARCHITECTS

PRICE B